

FILTER DRUM FD

Minimize fresh water usage in vegetable washing and industrial food processing.



General description

Minimize fresh water usage in vegetable washing and industrial food processing.

Filter drum is used to minimize fresh water usage in vegetable washing and industrial food processing via filtering the dirty water. The filtration process is done using a rotary drum where dirty water flows into the center of drum and passes through perforated drum screen to capture organic matter and other debris. The filter material is augured out of the machine to waste, while filter water is discharged back to washing process or water treatment plant.

Allround standard filter drum comes in frame of stainless steel AISI304, but bearings and idle/drive rollers are from mild steel.

The drum of filter drum can be supplied with either 2 or 3 mm opening, depending on amount of dirt. The capacity of machine is estimated about 180 m³ per hour, but also depends on the amount of dirt.

If required, the filter drum can be on subframe to accommodate height difference. The subframe can be made from painted mild steel, stainless steel AISI304 and galvanized steel. The height of the subframe can be varies from 0-7 meter.

All dimensions in cm

| | | FD 100 |
|---|-----------------------|--------|
| A | Length of the machine | 100 |
| B | Diameter of the drum | 60 |
| | | |
| | | |

All capacities are indications based on experience from the past and depend on the agro climatic, soil and logistic conditions of the product, Allround VP does not guarantee any of these.

Characteristics

- ✓ Diameter of drum is 100 cm
- ✓ Length of drum is 60 cm
- ✓ Drum made up of 2 or 3 mm round perforated holes
- ✓ Minimize fresh water usage in vegetable washing and industrial food processing
- ✓ Remove water from waste which reduce weight of waste, resulting in reduction of waste disposal costs
- ✓ Flip up door to give easy access to drum for cleaning and maintenance
- ✓ Spray bar sprays water through drum to avoid blockage of holes of perforated drum
- ✓ Stainless steel AISI304 frame construction

Options:

■ Material and treatment (frame)

| | |
|-----------------|---|
| Stainless steel | Frame is made from stainless steel AISI304. The bearings and drive/idle rollers are from mild steel |
|-----------------|---|

■ Drum

| | |
|-----------------------------|--|
| Perforated plate round 2 mm | The drum is made of perforated plate with rounds 2 mm The capacity of the machine depends on the amount of dirt |
|-----------------------------|--|

| | |
|-----------------------------|--|
| Perforated plate round 3 mm | The drum is made of perforated plate with rounds 3 mm The capacity of the machine is estimated at 180 m ³ per hour, but also depends on the amount of dirt |
|-----------------------------|--|

■ Electrical control

| | |
|-------------|------------------------------|
| No electric | Motors and necessary sensors |
|-------------|------------------------------|

| | |
|-------------|---|
| Stand-alone | Motors, necessary sensors and control panel. The length of the cable is 5, 10, 15 or 20 meter |
|-------------|---|

| | |
|-------------------------|------------------------------|
| Central control in line | Motors and necessary sensors |
|-------------------------|------------------------------|

■ Material and treatment (electrical panel)

| | |
|--------------------|--|
| Painted mild steel | The electrical panel is made from painted mild steel |
|--------------------|--|

| | |
|-----------------|---|
| Stainless steel | The electrical panel is made from stainless steel AISI304 |
|-----------------|---|

■ Material and treatment (subframe)

| | |
|--------------------|------------------------------------|
| Painted mild steel | It is made from painted mild steel |
|--------------------|------------------------------------|

| | |
|-----------------|---|
| Stainless steel | It is made from stainless steel AISI304 |
|-----------------|---|

| | |
|------------------|----------------------------------|
| Galvanized steel | It is made from galvanized steel |
|------------------|----------------------------------|

■ Height of subframe

| | |
|--------------------|--------------|
| Height of subframe | 0 to 7 meter |
|--------------------|--------------|

FD 100-60

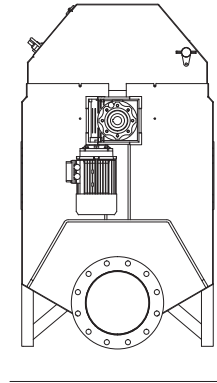
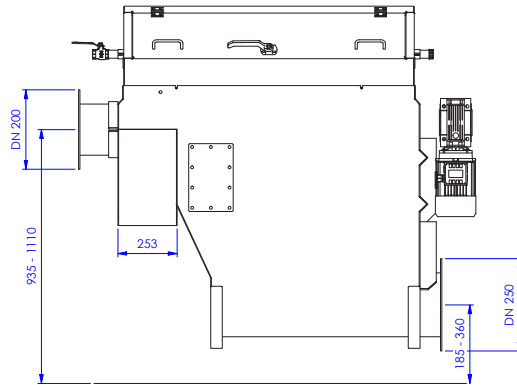
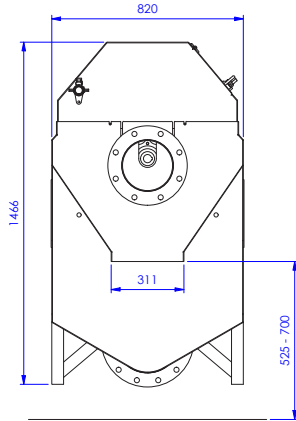
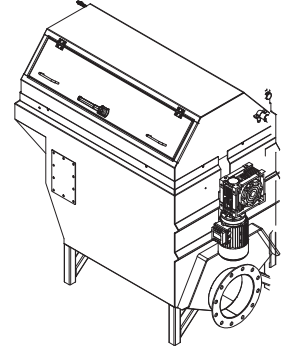
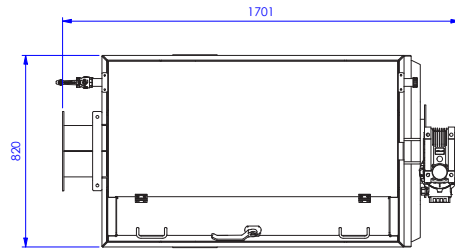
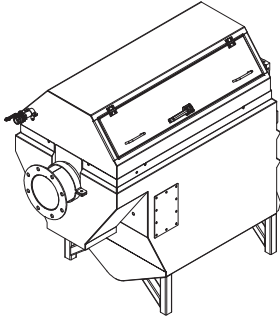

For discussion only!
 The dimensions are approximately.
 We are free to resize and change the machines,
 when we deem it necessary.

| | | | |
|---|--|---------------------|--|
| Project: Third party machines | | Revision: 00 | |
| Description: Filler drum FD 100-60 (Verhoef 1003.247.0001) | | | |
| Engineer: SRPL | | Scale: 1:15 | |
| Date: 18-12-2024 | | Sheet size: A3 | |
| Unit: mm | | Sheet: 1 of 2 | |
| 00241754 | | | |