

## BOX TIPPER ZT

Box tipper empties filled boxes with controlled flow into wet/dry hopper or transport conveyor depending upon the design of your line.

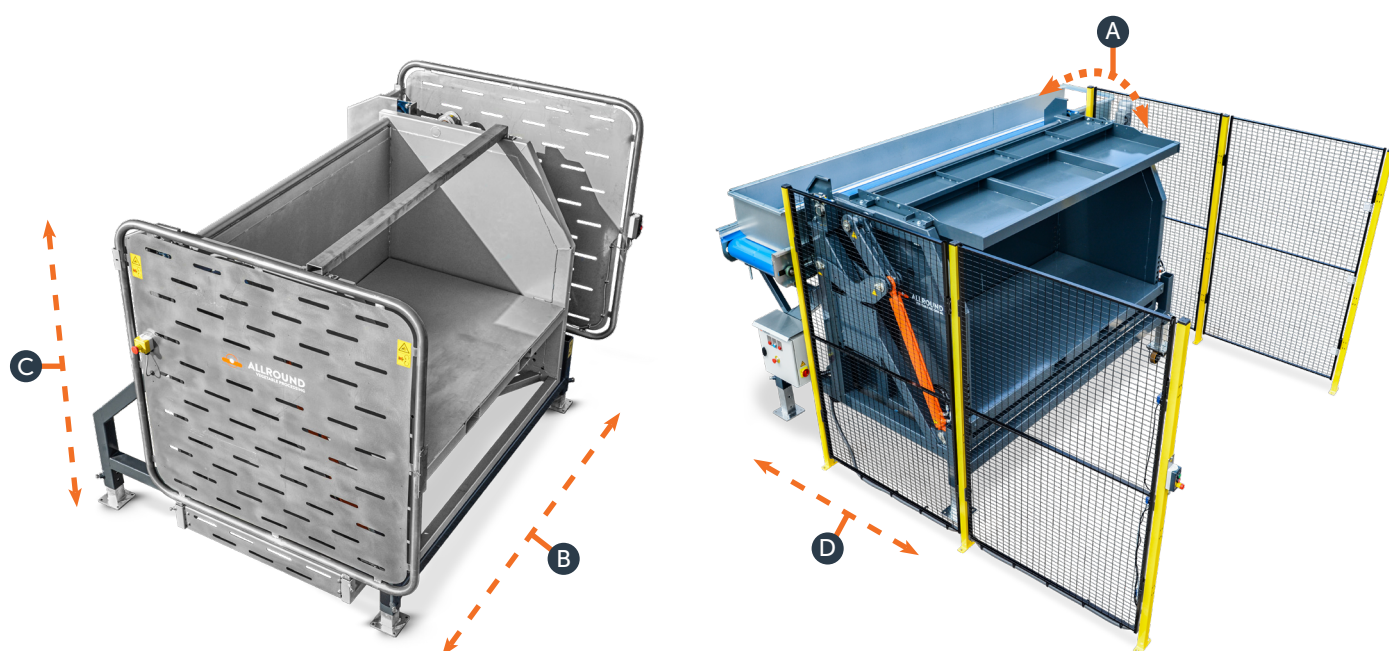

### General description

This box tipper is designed to empty various-sized filled boxes into either a wet/dry hopper or a transport conveyor, depending on the design of your line. On demand, the machine can be controlled remotely using a wireless remote control.

A box with produce is loaded into the box tipper by a forklift. After pressing the start button, the tipping motion begins. The box rotates to an angle of 140°, so all produce is dumped into the next position. The empty box will automatically return to the default position. The cycle can be stopped at any time.

On demand, a sensor can be installed to detect and control the produce output. This sensor sends a signal to start or stop the rotation of the box.

On demand, safety fences, a siren & warning lights can be provided to enhance safety.

All dimensions in cm

		ZT 120	ZT 160	ZT 180	ZT 240
A	Rotation angle (max in deg)	170	170	170	170
B	Width of the box (min - max)	80-120	80-160	80-180	80-240
C	Height of the box (min - max)	85-125	85-125	85-125	85-125
D	Depth of the box (min - max)	80-120	80-120	80-120	80-120
E	Weight of the box (max in kg)	1200	1500	1750	2500

All capacities are indications based on experience from the past and depend on the agro climatic, soil and logistic conditions of the product, Allround VP does not guarantee any of these.

## Characteristics

- ✓ Models available for 1200, 1600, 1800 & 2400 mm wide boxes
- ✓ A heavy-duty cylinder is used so that it can handle heavy load requirements
- ✓ Durable and robust construction to handle heavy loads & forklift impacts
- ✓ Tipping rotation to 170° ensures complete discharge of produce
- ✓ The maximum weight of the box varies from 1200 to 2500 kg
- ✓ On demand, a subframe can be made to overcome a height difference
- ✓ On demand, a wireless remote control can be provided
- ✓ On demand, a sensor can be installed to detect and control the produce output
- ✓ On demand, a shake function can be included to take out the last produce left in the box
- ✓ On demand, safety fences, a siren & warning lights can be provided to enhance safety

## Options:

### ■ Material and treatment (frame)

Painted mild steel	Frame and plating is made from painted mild steel. The bearings and drive/idle rollers are from mild steel.
Hot dipped galvanized	Frame is made from hot dipped galvanized steel. The bearings and drive/idle rollers are from mild steel. The plating is from stainless steel.

### ■ Electrical control

Stand-alone	Motors, necessary sensors, switch box and control box.
-------------	--

### ■ Material and treatment (electrical panel)

Painted mild steel	The electrical panel is made from painted mild steel.
Stainless steel	The electrical panel is made from stainless steel.

### ■ Wireless remote control

Wireless	A wireless remote control is included. The machine can be controlled from a distance.
----------	---

### ■ Safety fence

Fence	Safety fences with a sensor are included. The sensor detects if someone walks between the fences and will stop the functioning of the machine.
-------	--

### ■ Emptying function

Shake function	The box can be shaken to try take out the last product left in the box.
----------------	---

### ■ Dosing function

Dosing sensor	A dosing sensor detects when the produce piles up on the belt and when the box needs to be stopped or lifted.
---------------	---

## ZT 160

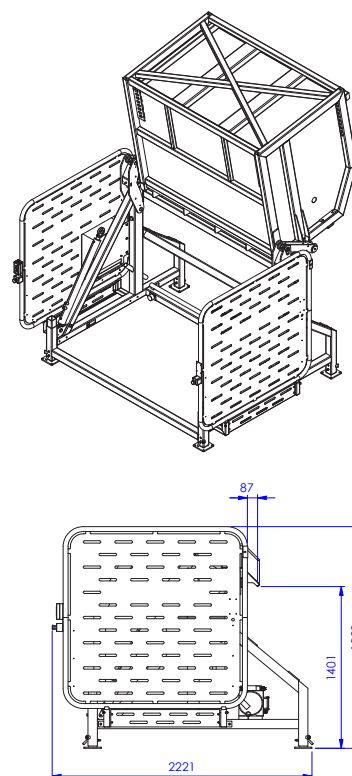
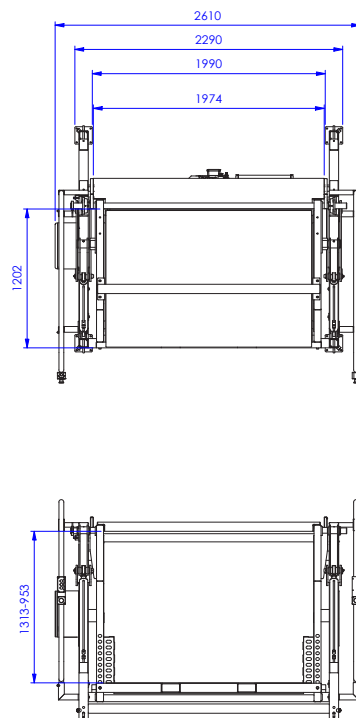
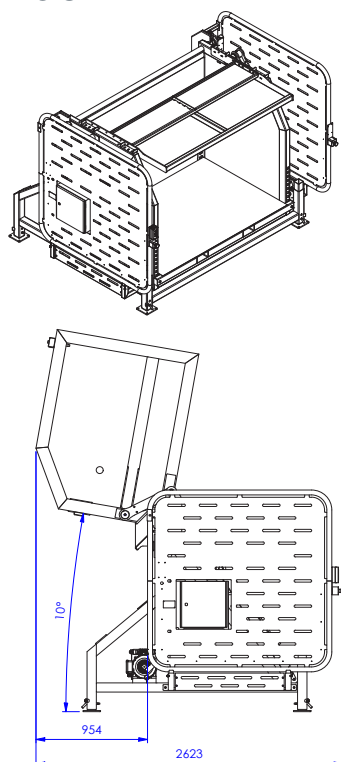

For discussion only!  
 The dimensions are approximately.  
 We are free to resize and change the machines,  
 when we deem it necessary.

For principle: ISO 8015	General tolerances: ISO 20148	Fit system: ISO 286	Geometrical tolerancing: ISO 1101
Project: <b>Box tipper</b>			
Description: <b>ZT 160</b>			
Surface: - - -			
Engineer: SRPL	Scale: 1 : 30	<b>00150038</b>	Revision: 01
Date: 12-5-2022	Sheet size: A3	Unit: mm	Sheet: 1 of 3

## ZT 240

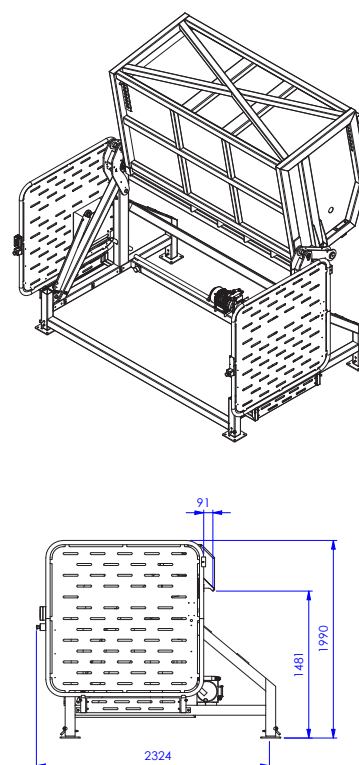
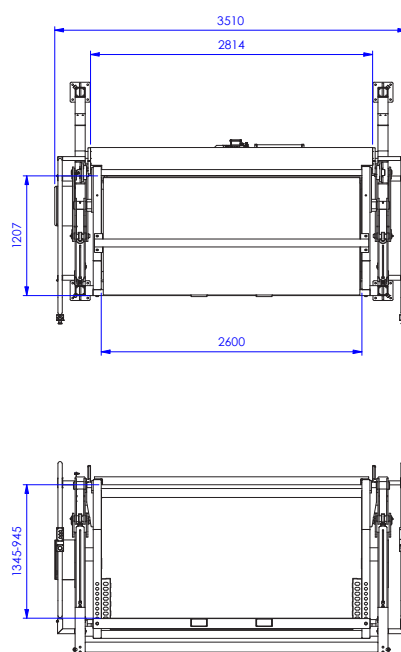
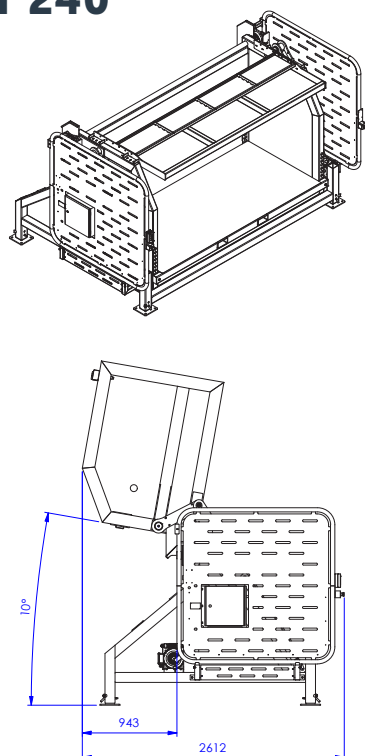

For discussion only!  
 The dimensions are approximately.  
 We are free to resize and change the machines,  
 when we deem it necessary.

For principle: ISO 8015	General tolerances: ISO 20148	Fit system: ISO 286	Geometrical tolerancing: ISO 1101
Project: <b>Box tipper</b>			
Description: <b>ZT 240</b>			
Surface: - - -			
Engineer: SRPL	Scale: 1 : 35	<b>00187910</b>	Revision: 00
Date: 2-5-2022	Sheet size: A3	Unit: mm	Sheet: 1 of 3